

- 1
- 2
- 3
- 4
- 5
- 6
- 7
- 8
- 9
- 10
- 11
- 12
- 13
- 14
- 15
- 16
- 17
- 18
- 19

**MATERIAL**

AISI 303 stainless steel, sand-blasted matte finish.

**FEATURES AND APPLICATIONS**

GN 184.5 washers are generally used on shafts to fit handwheels with an axial keyway.



Conversion Table	
1 mm = 0,039 inch	
d1	
mm	inch
12	0.47
16	0.62
20	0.78
22	0.86
25	0.98
28	1.09
32	1.25
36	1.37
40	1.56
45	1.76
52	2.03

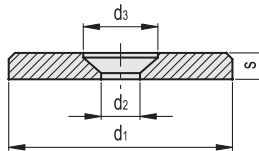

Code	Description	d1	d2	d3	s	Countersunk screws	⚖️
GN.31219	GN 184.5-12	12	3.2	6.5	2.5	M3	2
GN.31221	GN 184.5-16	16	4.3	8.5	3	M4	4
GN.31223	GN 184.5-20	20	4.3	8.5	3	M4	6
GN.31225	GN 184.5-22	22	5.3	10.3	3.5	M5	9
GN.31227	GN 184.5-25	25	5.3	10.3	3.5	M5	12
GN.31229	GN 184.5-28	28	5.3	10.3	3.5	M5	15
GN.31231	GN 184.5-32	32	6.4	12.3	4	M6	22
GN.31233	GN 184.5-36	36	6.4	12.3	4	M6	28
GN.31235	GN 184.5-40	40	6.4	12.3	5	M6	46
GN.31237	GN 184.5-45	45	6.4	12.3	6	M6	70
GN.31239	GN 184.5-52	52	6.4	12.3	6	M6	95

Standard machine parts